

INDUSTRIAL FOR LEASE

3280 & 3284 EDWARD AVE, SANTA CLARA, CA

Call Agent to Show

Property Highlights

3280 EDWARD AVE, UNIT C

±6,048 SF with ±800 SF of office

Two (2) grade level doors

200 Amps; 120/208 Volts (tenant to verify)

Asking Rate: \$1.55 IG + \$0.13 CAM

3284 EDWARD AVE, UNIT E

±3,946 SF with ±500 SF of office

One (1) grade level door

400 Amps; 120/208 Volts (tenant to verify)

Asking Rate: \$1.65 IG + \$0.13 CAM

STEVE ZAMUDIO, CCIM

408.888.7529

steve.zamudio@kidder.com

LIC N° 00905956

KIDDER.COM

This information supplied herein is from sources we deem reliable. It is provided without any representation, warranty, or guarantee, expressed or implied as to its accuracy. Prospective Buyer or Tenant should conduct an independent investigation and verification of all matters deemed to be material, including, but not limited to, statements of income and expenses. Consult your attorney, accountant, or other professional advisor.



FLOOR PLANS

3280 EDWARD AVE, UNIT C

±6,048 SF

AVAILABLE

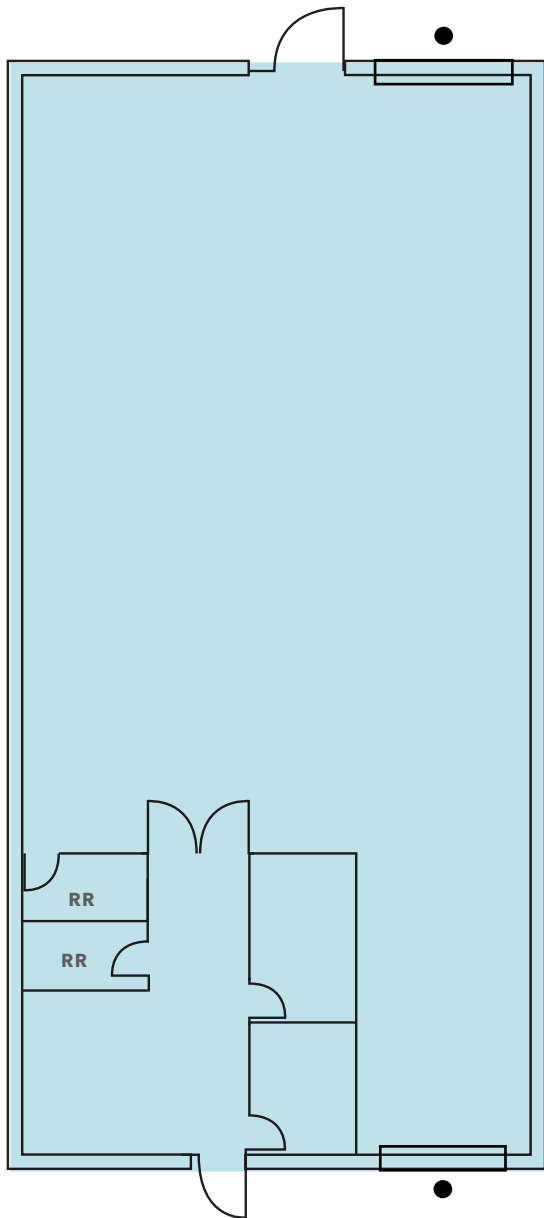

3284 EDWARD AVE, UNIT E

±3,946 SF

AVAILABLE

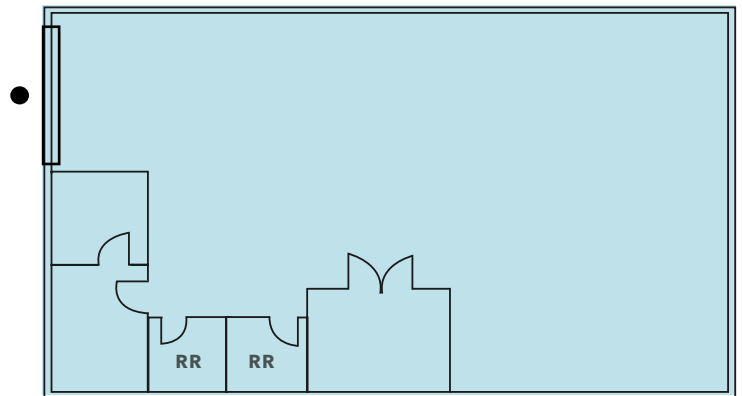

● Grade Level Door

FLOOR PLAN NOT EXACT OR TO SCALE

KIDDER.COM

This information supplied herein is from sources we deem reliable. It is provided without any representation, warranty, or guarantee, expressed or implied as to its accuracy. Prospective Buyer or Tenant should conduct an independent investigation and verification of all matters deemed to be material, including, but not limited to, statements of income and expenses. Consult your attorney, accountant, or other professional advisor.

SITE PLAN

3280 EDWARD AVE

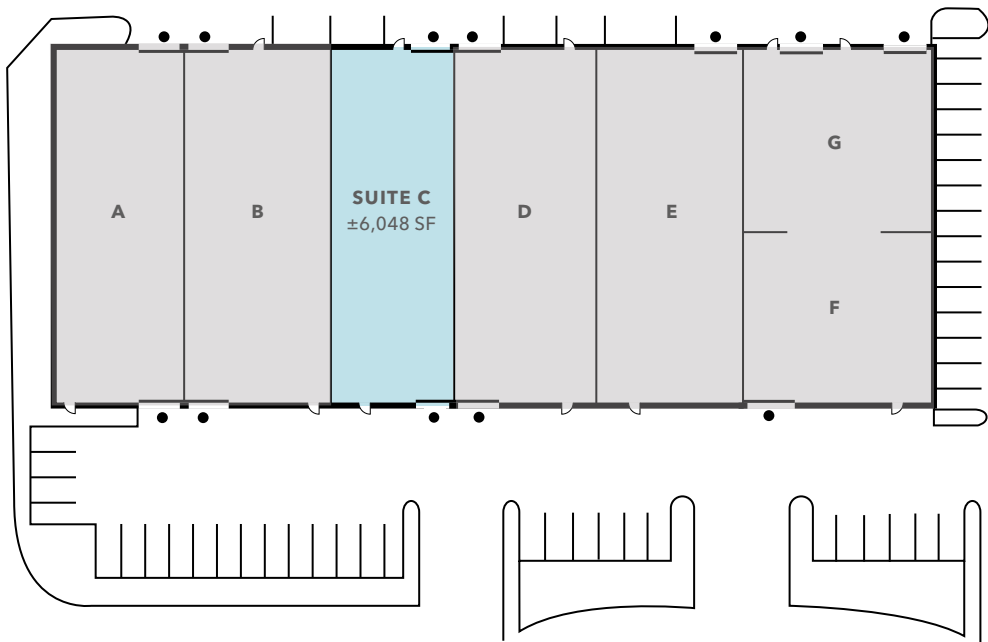

3284 EDWARD AVE

