

FOR LEASE

# 821 MARTIN AVENUE

*±22,741 SF R&D/Manufacturing  
Available For Lease in Santa Clara, CA*

SANTA CLARA, CA



CUSHMAN &  
WAKEFIELD



Kidder  
Mathews





Grade level door

CLEAR HEIGHT



**Kidder  
Mathews**



FOR LEASE

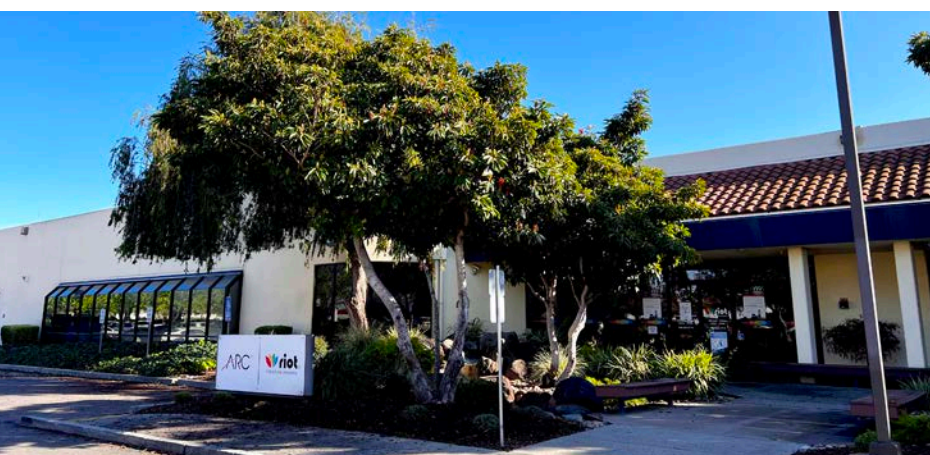

KIDDER.COM

This information supplied herein is from sources we deem reliable. It is provided without any representation, warranty, or guarantee, expressed or implied as to its accuracy. Prospective Buyer or Tenant should conduct an independent investigation and verification of all matters deemed to be material, including, but not limited to, statements of income and expenses. Consult your attorney, accountant, or other professional advisor.





FOR LEASE



**KIDDER.COM**

This information supplied herein is from sources we deem reliable. It is provided without any representation, warranty, or guarantee, expressed or implied as to its accuracy. Prospective Buyer or Tenant should conduct an independent investigation and verification of all matters deemed to be material, including, but not limited to, statements of income and expenses. Consult your attorney, accountant, or other professional advisor.



# 821 MARTIN AVENUE

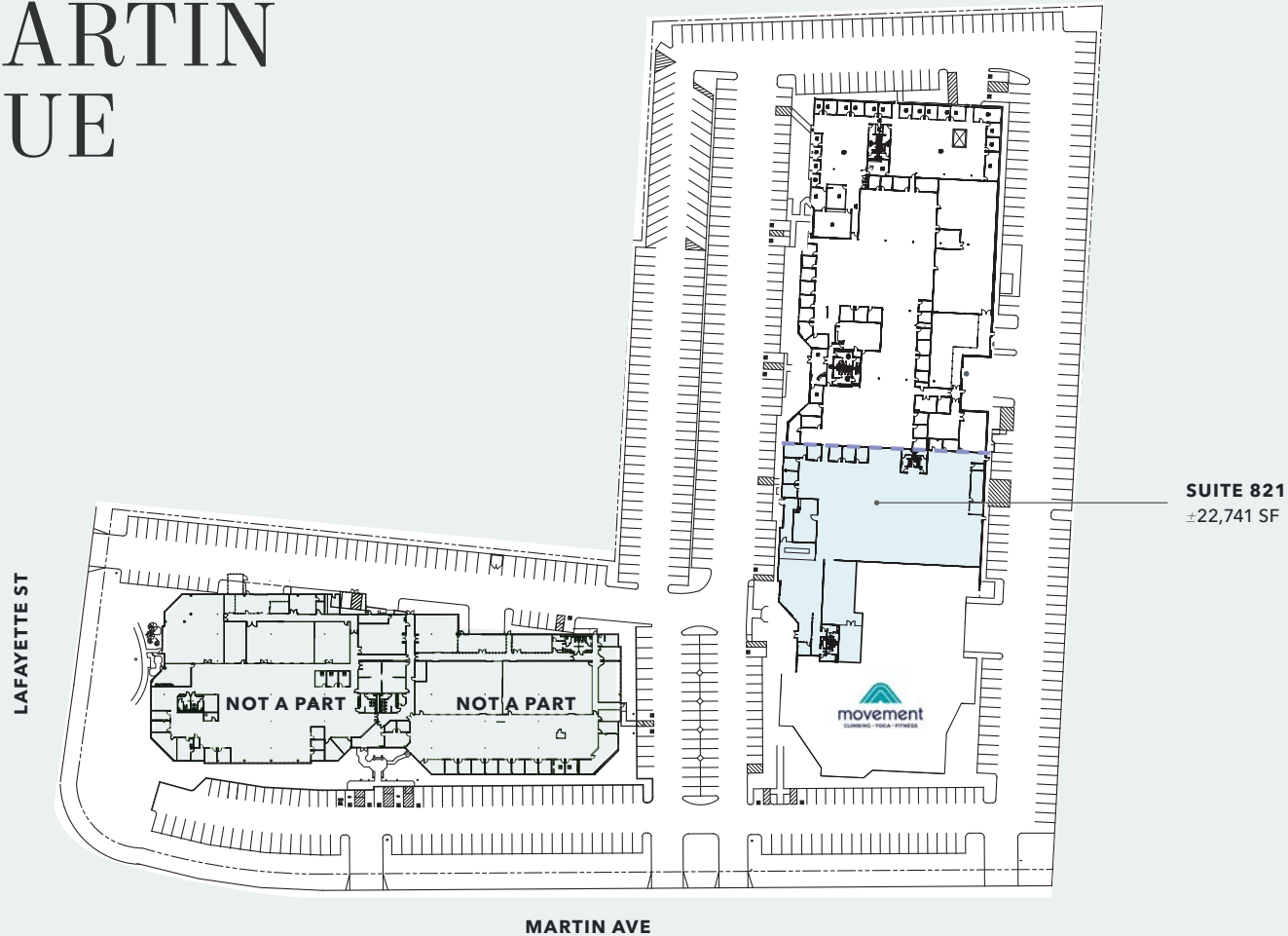

*For more information, contact*

**DAVE GEISSBERGER**

Kidder Mathews

408.588.2338

dave.geissberger@kidder.com

LIC N° 01401887

**KALIL JENAB**

Cushman & Wakefield

408.810.3428

kalil.jenab@cushwake.com

LIC N° 00848988

**STEVEN ALI JENAB**

Cushman & Wakefield

408.718.1804

steven.jenab@cushwake.com

LIC N° 02085072

KIDDER.COM

This information supplied herein is from sources we deem reliable. It is provided without any representation, warranty, or guarantee, expressed or implied as to its accuracy. Prospective Buyer or Tenant should conduct an independent investigation and verification of all matters deemed to be material, including, but not limited to, statements of income and expenses. Consult your attorney, accountant, or other professional advisor.

